

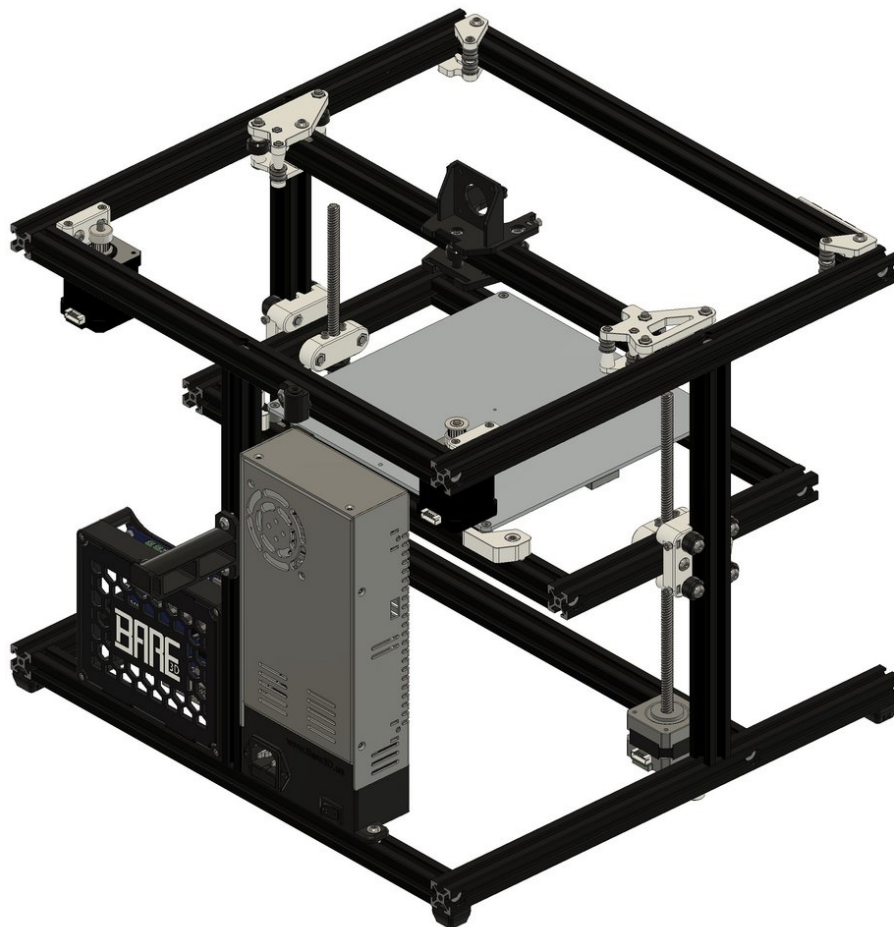

Section 1.7: Attaching XY Gantry. Spool Holder, Filament Guide and Pulley Brackets

Written By: Leland Crowther



Step 1 — Prepare Parts

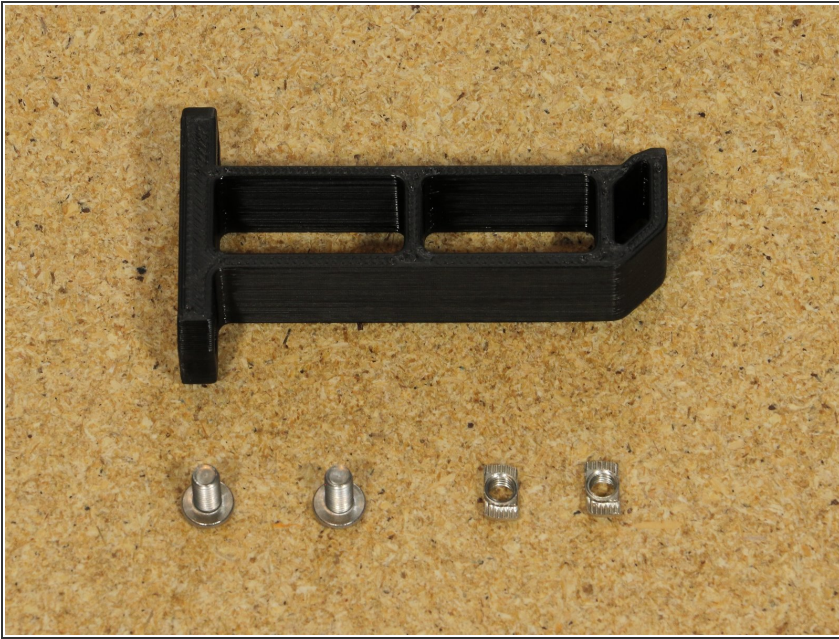

- Spool Holder 19A (1x)
- M5x10 button head cap screw (2x)
- M5 Drop-in T Nut (2x)

Step 2 — Attach Spool Holder



- Attach Spool Holder with M5x10 screws and M5 drop-in T-nuts

Step 3 — Prepare Parts

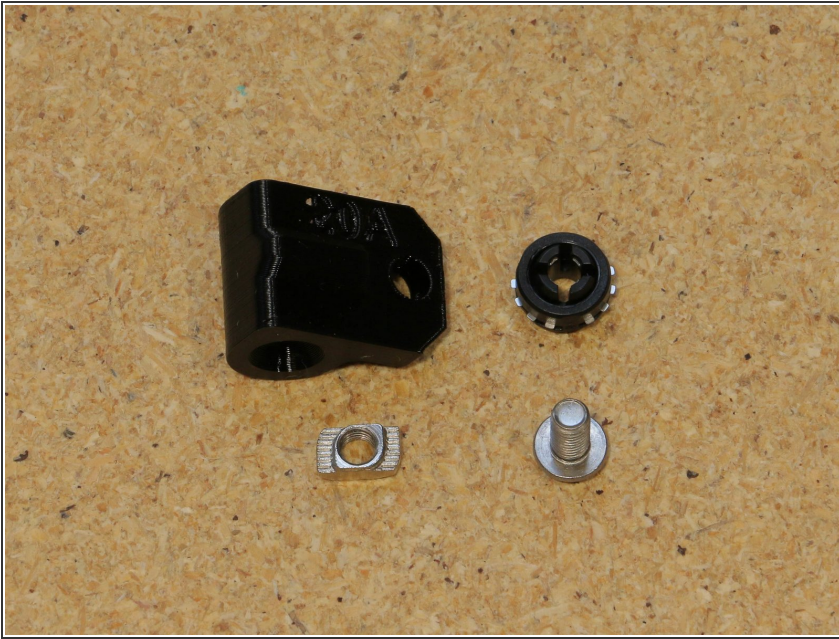

- Bowden Tube Holder 20A (1x)
- Bowden Coupling (1x)
- M5x10 screw (1x)
- M5 Drop-in T-Nut (1x)

Step 4 — Preparing and Mounting Bowden Tube Holder

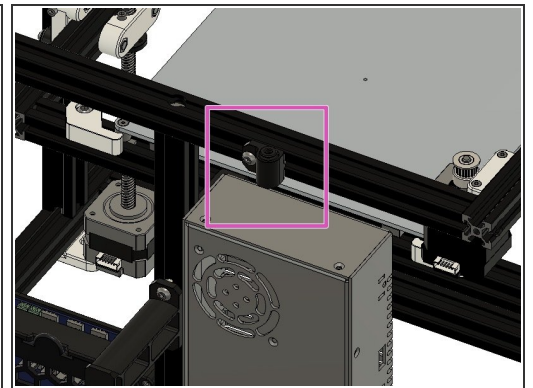
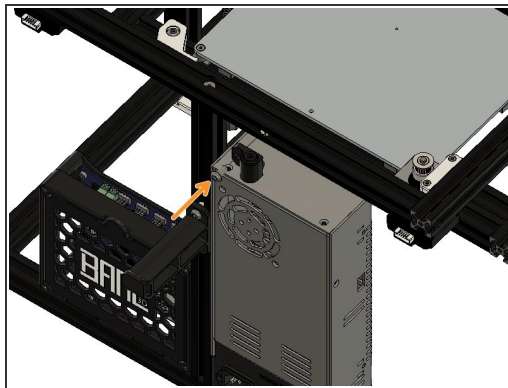
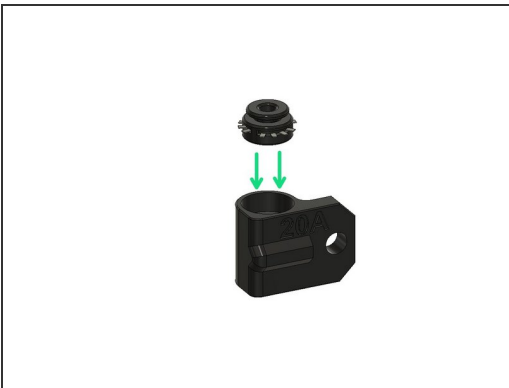

- Press Bowden Coupling into Bowden Tube Holder 23A
- Mount bowden tube holder assembly to frame using M5x10 screw and drop-in T-nut (exact position not important)

Step 5 — Prepare Parts

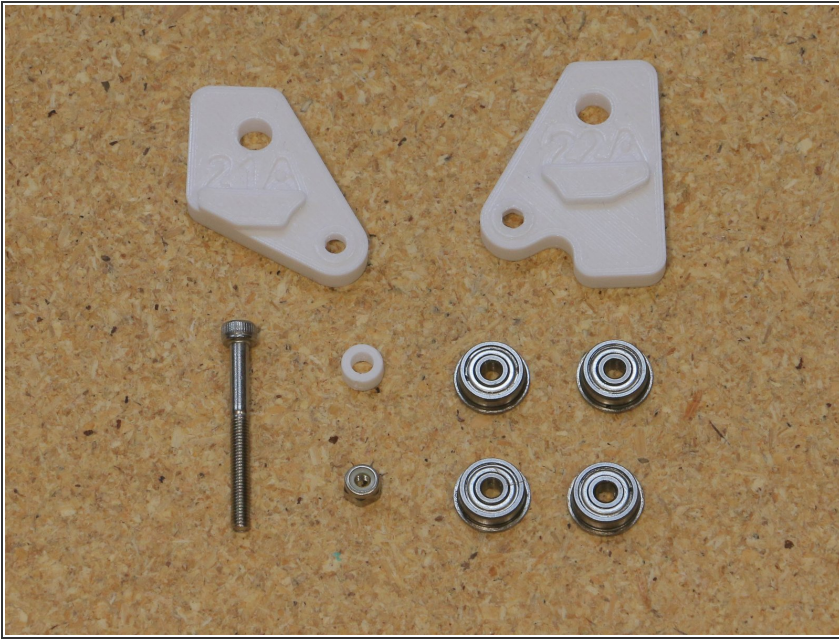

- Pulley Bracket (top) L 21A (1x)
- Pulley Bracket (bottom) L 22A (1x)
- Belt Pulley (4x)
- Pulley Spacer 3mm (1x)
- M3x30 socket head screw (1x)
- M3 Nylock Nut (1x)

Step 6 — Assemble Pulley Brackets (Left)

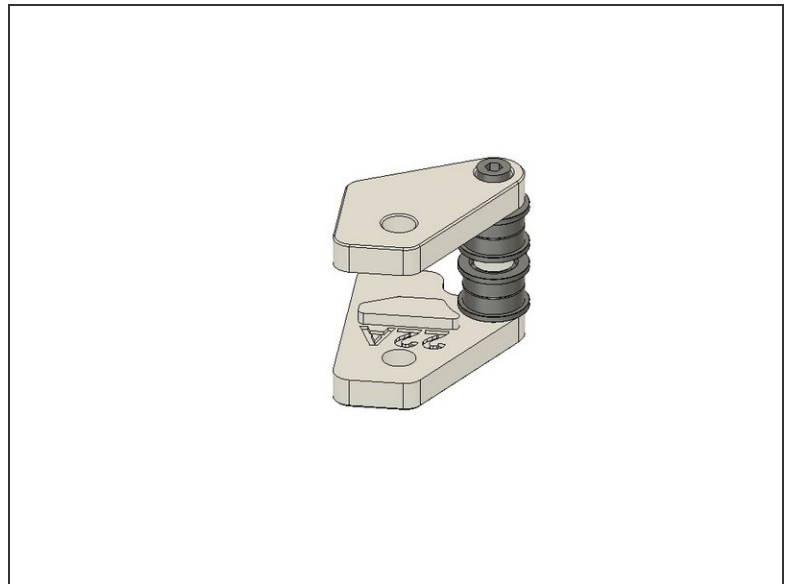
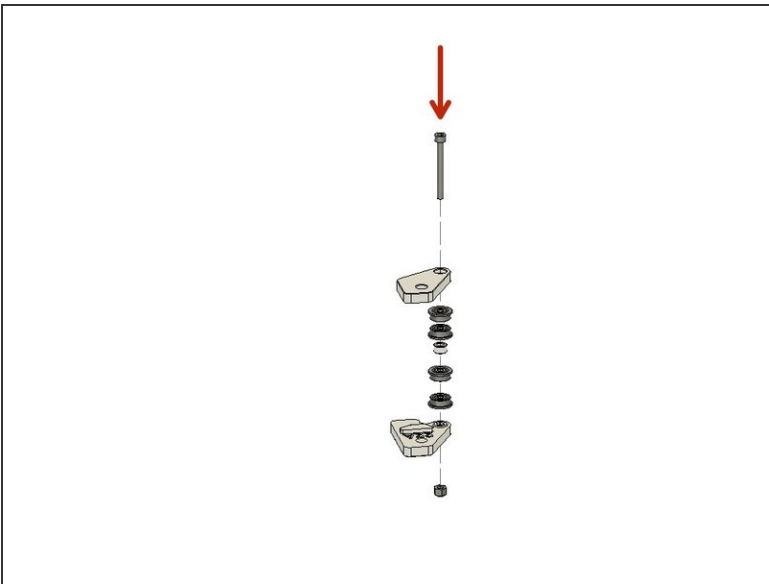

- Assemble pulley brackets

Step 7 — Parts Required



- M5x10 button head cap screw (x2)
- M5 drop in T nut (x2)
- Pulley bracket assembly left (x1)

Step 8 — Mount Pulley Bracket Assembly (Left) to Frame

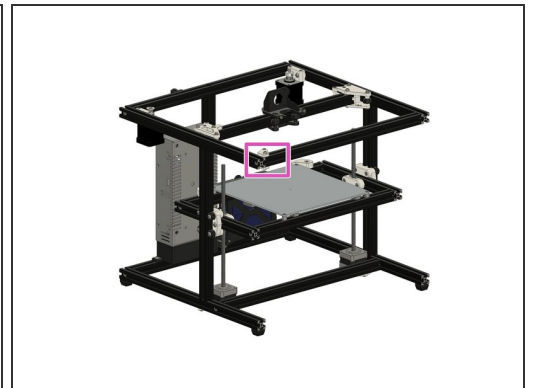
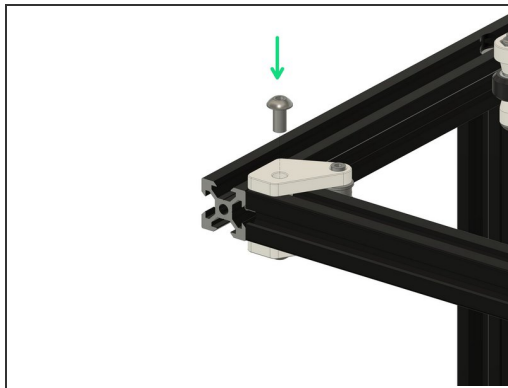
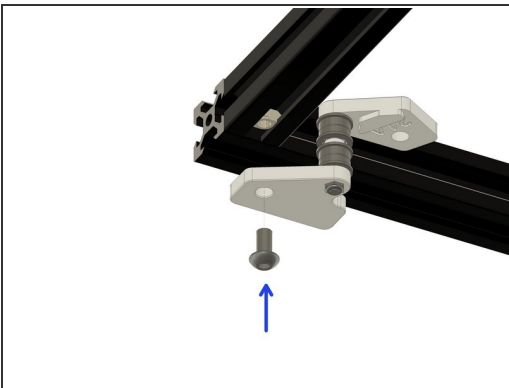

- Mount Pulley Bracket to frame using M5x10 screw and drop-in T-nut
- Mount Pulley Bracket to frame using M5x10 screw and drop-in T-nut
- Shown mounted on printer

Step 9 — Prepare Parts

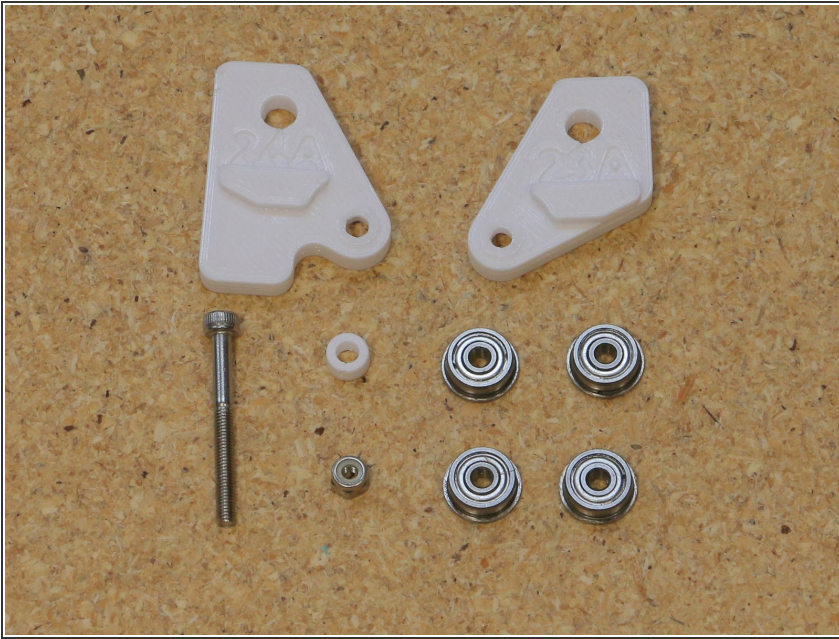

- Pulley Bracket (top) R 23A (1x)
- Pulley Bracket (bottom) R 24A (1x)
- Belt Pulley (4x)
- Pulley Spacer 3mm (1x)
- M3x30 socket head screw (1x)
- M3 Nylock Nut (1x)

Step 10 — Assemble Pulley Brackets (Right)

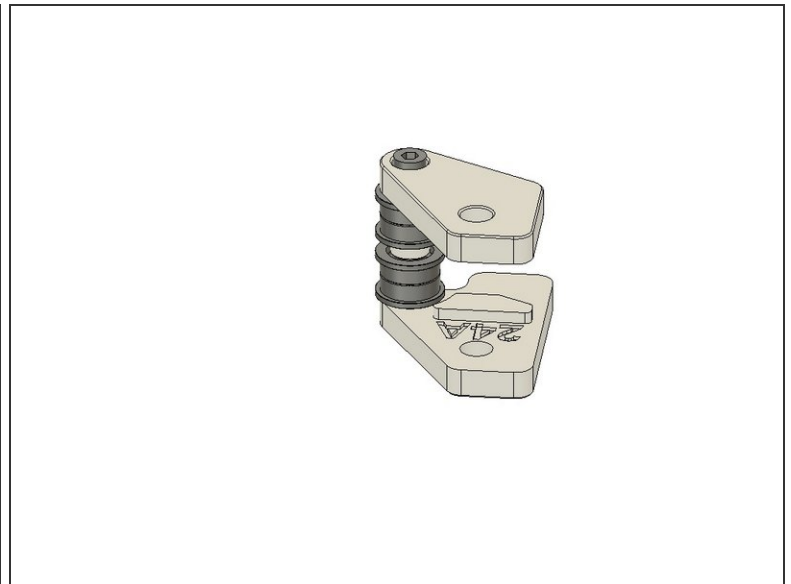
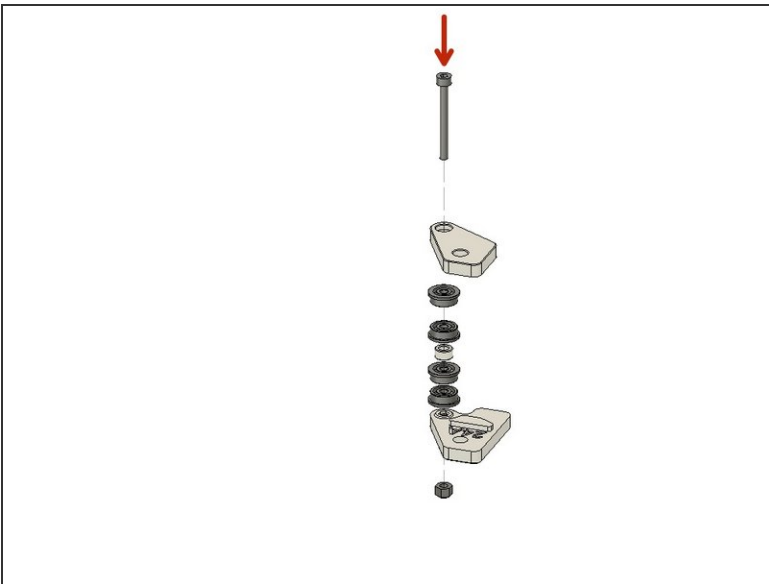

- Assemble pulley brackets

Step 11 — Parts Required



- M5x10 button head cap screw (x2)
- M5 drop in T nut (x2)
- Pulley bracket assembly right (x1)

Step 12 — Mount Pulley Bracket Assembly (Right) to Frame

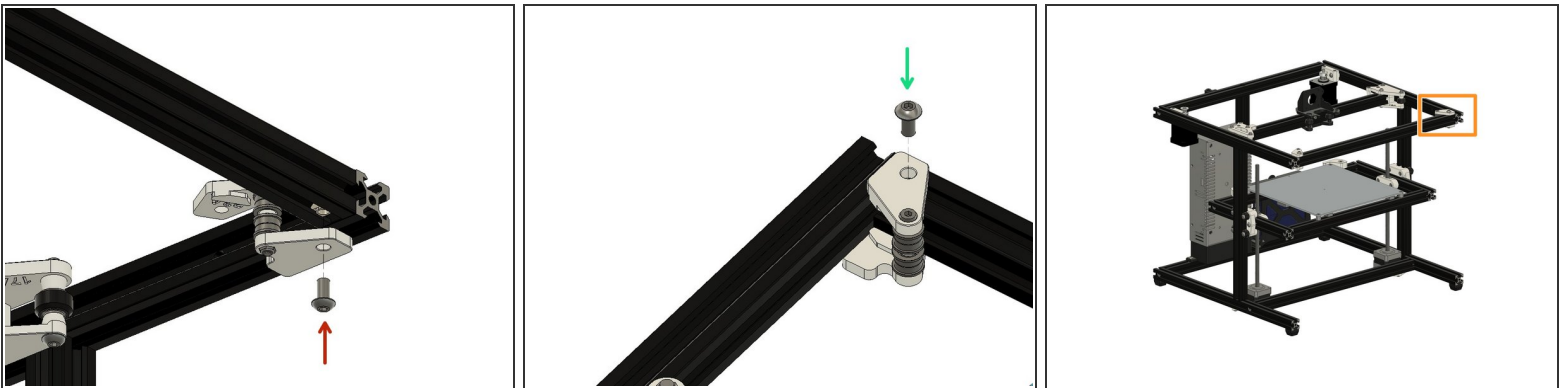

- Mount Pulley Bracket to frame using M5x10 screw and drop-in T-nut
- Mount Pulley Bracket to frame using M5x10 screw and drop-in T-nut
- Location on printer for reference

Step 13 — Prepare Parts



- Gantry Assembly (1x)

Step 14 — Installing XY Gantry

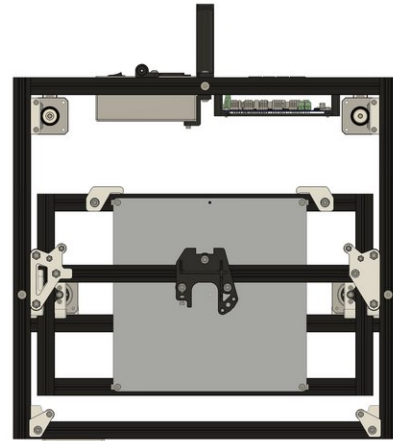
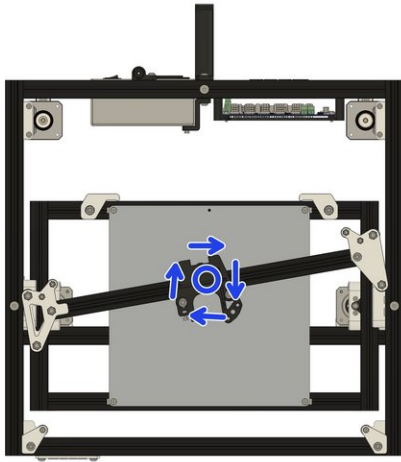

- Line V wheels up with V slot vertically then pivot into position. (Y carriages should be loose enough to pivot slightly)
- ⓘ Tip: be gentle with gantry while it is still loose and could fall out. It will be solid after preloading is done later

Step 15 — Prepare Parts



- Printed Logo 28A (1x)
- M5x8 button head cap screw (2x)
- M5 Drop-in T Nut (2x)

Step 16 — Attach Logo

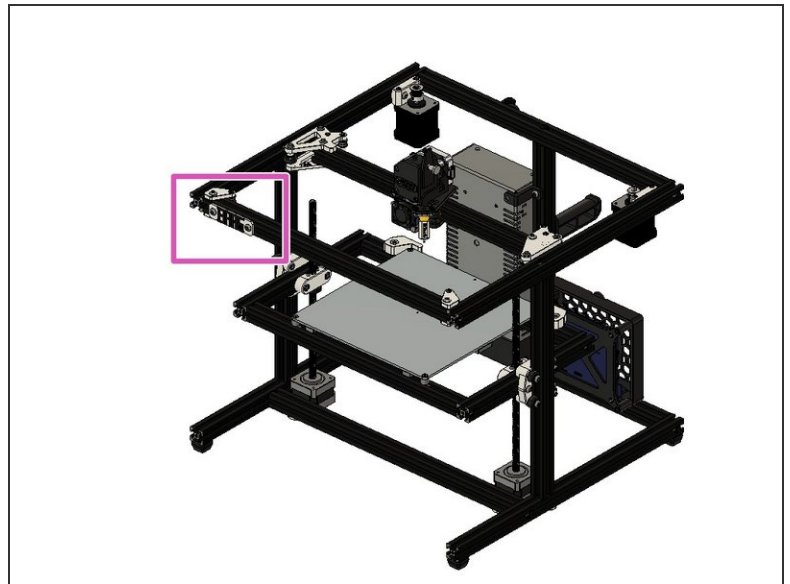
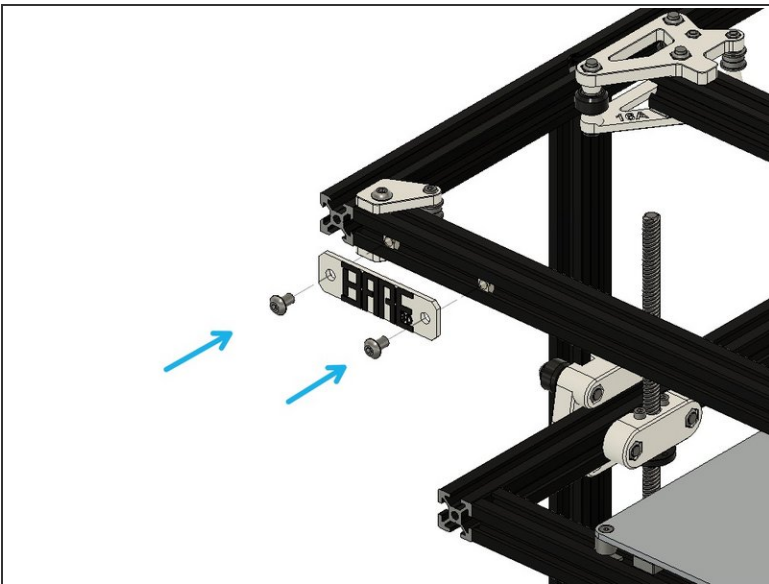

- Attach logo with M5x8 screws and M5 Drop-in T Nut.
- Mounted logo