



Section 1.9: Applying PEI to Flexplate

Written By: Leland Crowther



Step 1 — Prepare Parts



- BuildTak FlexPlate 9" x 10" (1x)
- 9" x 9" PEI sheet with pre-applied 3M adhesive (1x)

Step 2 — Prepare to Apply PEI

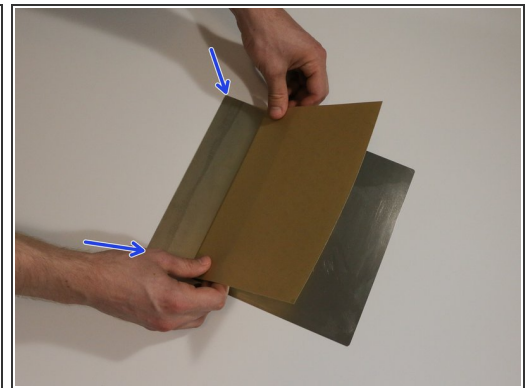
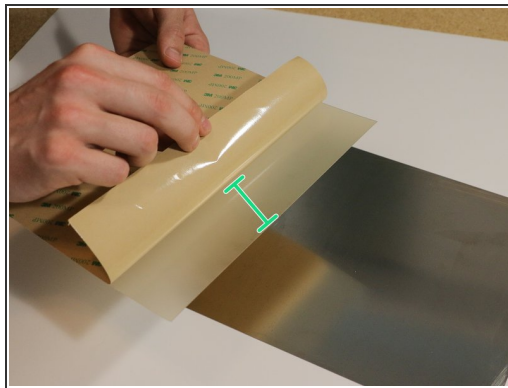
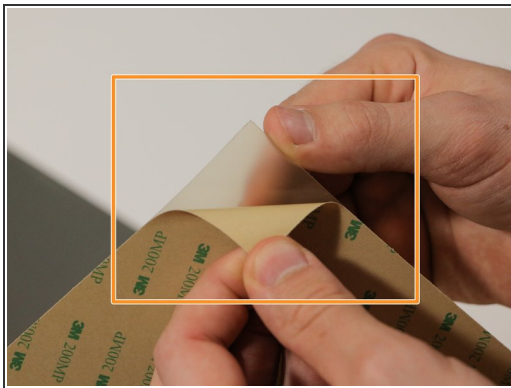

- Remove warning sticker and clean Buildtak Flexplate with rubbing alcohol
- Peel back corner on PEI sheet
- Peel back about a quarter of the sheet
- Line up corners of PEI and Flexplate

Step 3 — Apply PEI

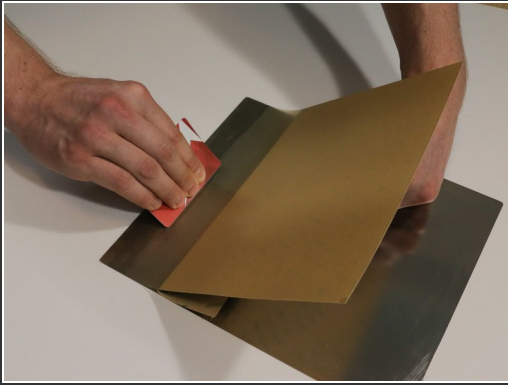

- Use a credit card to slowly work your way across PEI

 Do your best to avoid bubbles