



Section 1.1: Base Frame, Z Motors, Rubber Feet

Written By: Leland Crowther



Step 1 — Prepare Parts

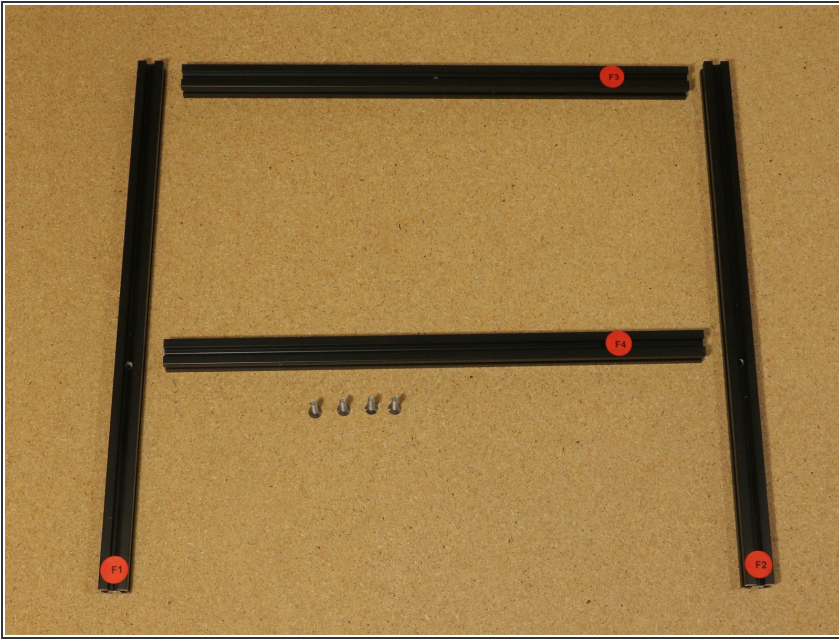

- M5x25 countersunk screw (4x)
- F1 (1x)
- F2 (1x)
- F3 (1x)
- F4 (1x)

Step 2 — Assemble Base Frame

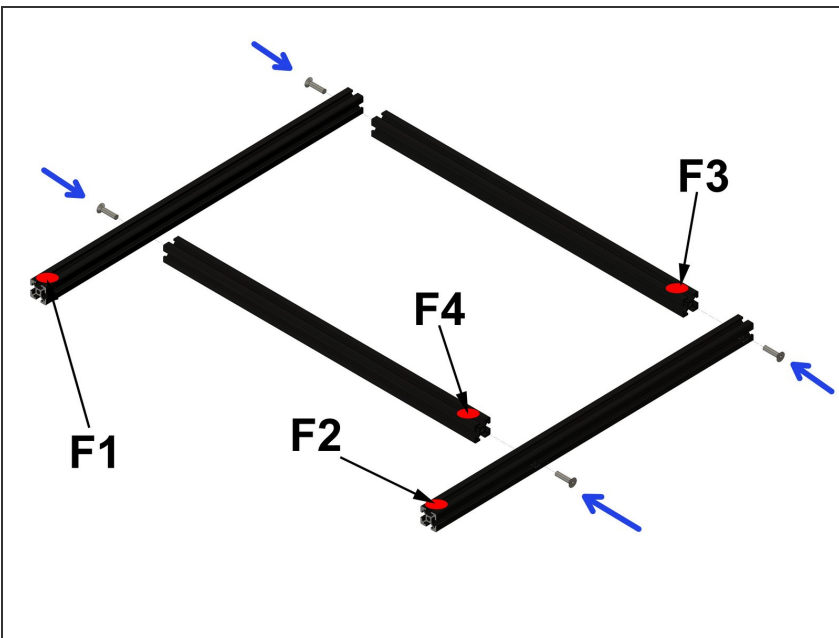

- Insert M5x25 screws.
- ❗ Tip: Pay attention to locations of stickers. Stickers should be oriented up.

Step 3 — Prepare Parts

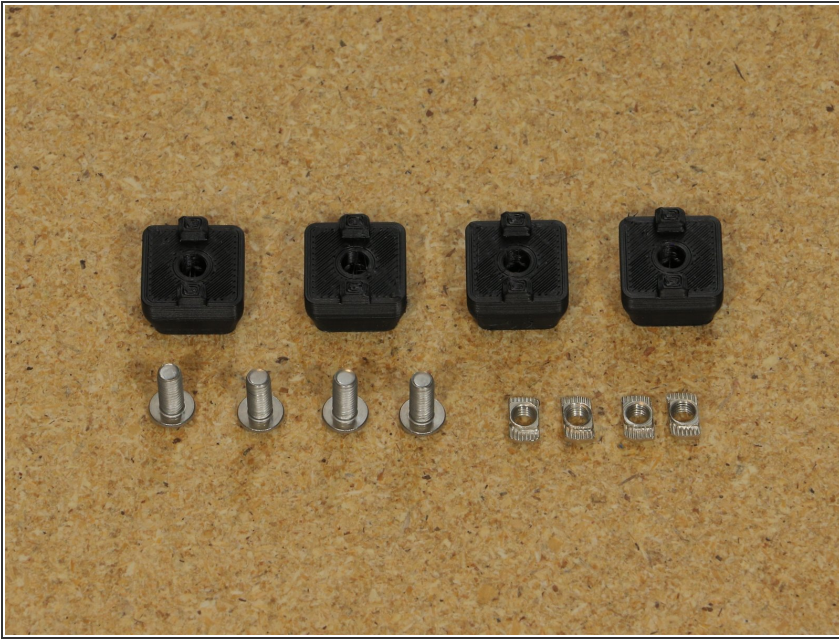

- Assembled Base Frame (step 1-2) (1x)
- Rubber Feet 1A (4x)
- M5 Drop- In T Nut (4x)
- M5x10 button head screw (4x)

Step 4 — Connect Feet to Base Frame

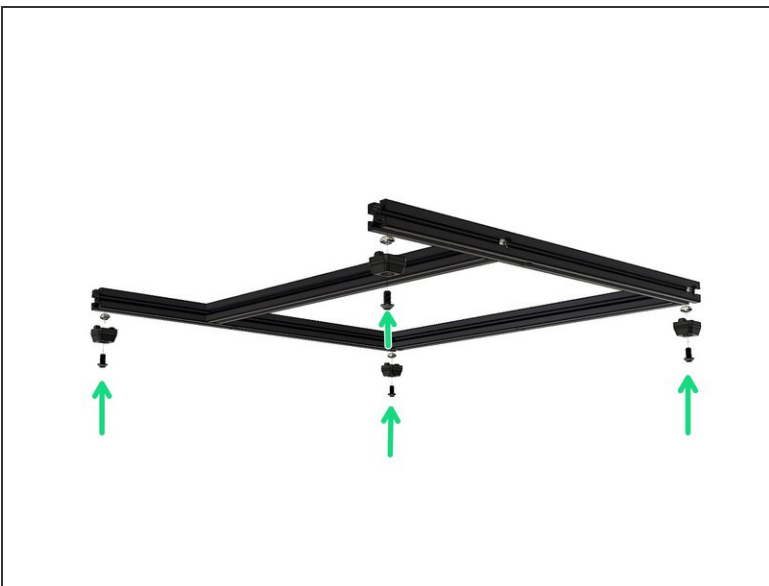

- Screw rubber feet on with M5x12 screws and drop-in T nut.

i Tip: Make sure feet screw onto the bottom of the frame (opposite side from stickers)

Step 5 — Prepare Parts

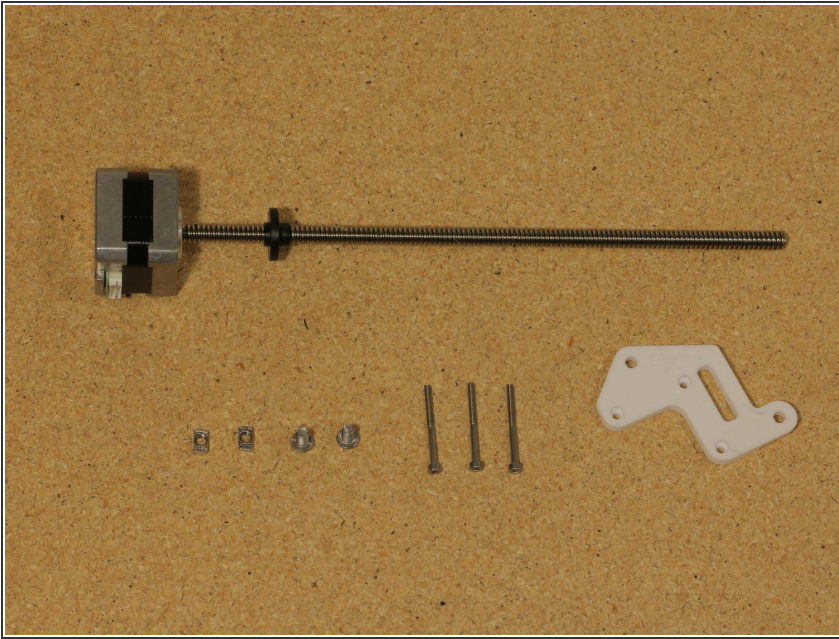

- Z Motor L (1x)
- Z Motor Bracket L 3A (1x) [mirror of right]
- M5x10 button head cap screw (2x)
- M5 Drop In T Nut (2x)
- M3x35 socket head screw (3x)

Step 6 — Assemble Z Motor Assembly L

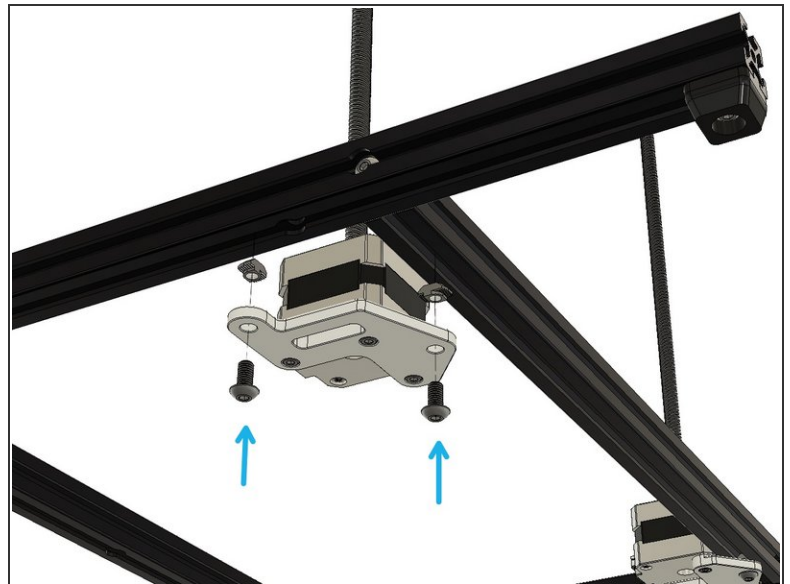
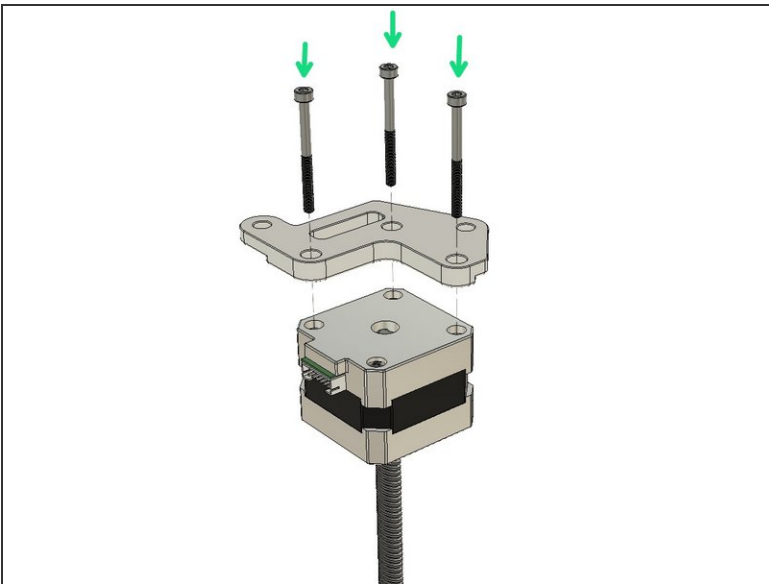

- Attach Z Motor Bracket L 3A with M3x30 screws to Z Motor L
- Attach Z motor assembly left to frame

Step 7 — Prepare Parts

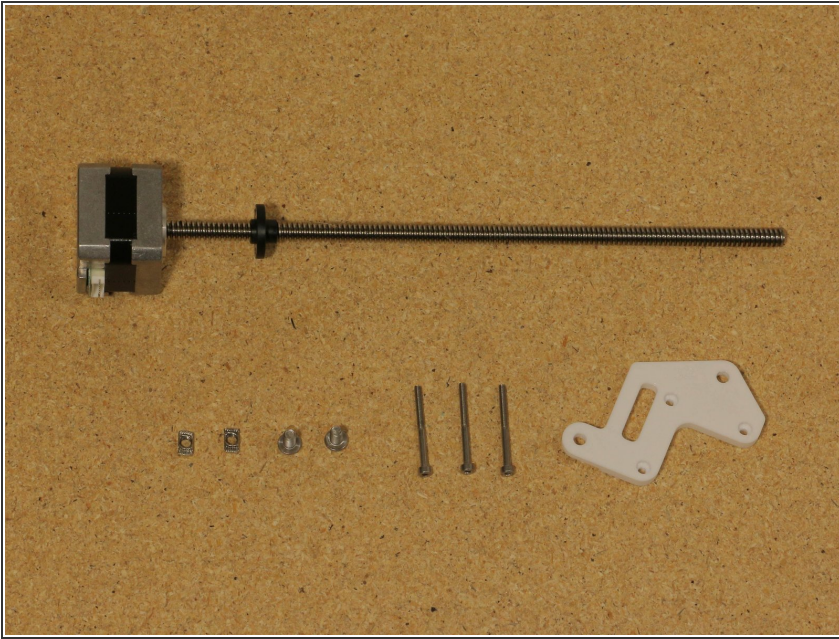

- Z Motor L (1x)
- Z Motor Bracket L 2A (1x) [mirror of left]
- M5x10 button head cap screw (2x)
- M5 Drop In T Nut (2x)
- M3x35 socket head screw (3x)

Step 8 — Assemble Z Motor Assembly R (Mirror of Left)

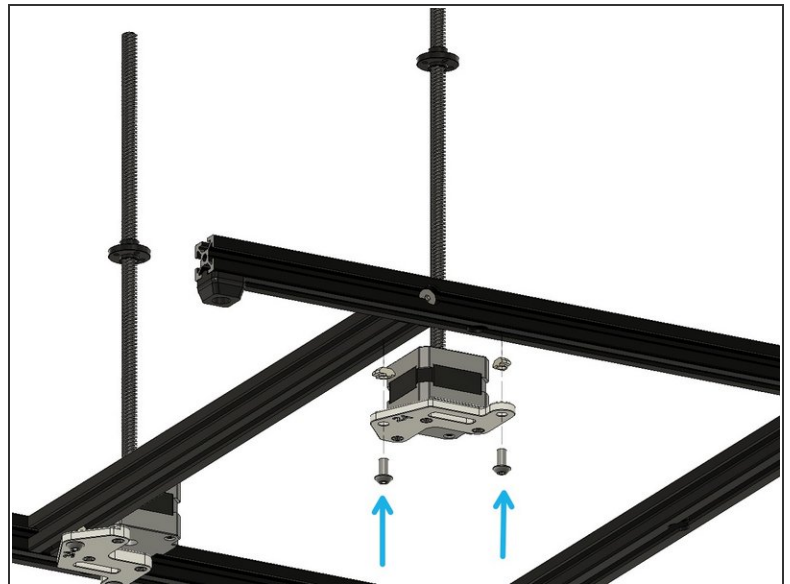
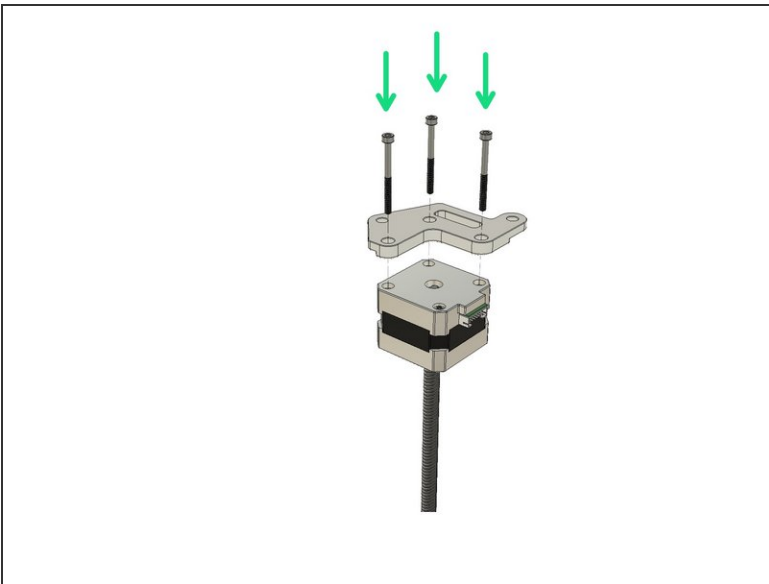

- Attach Z Motor Bracket L 2A with M3x30 screws to Z Motor R
- Attach Z motor assembly right to frame